

Triumph

Executive Desking

Pricelist

August 2009



Section/Product	Page
Standard Product Overview	3
Desks	4
Credenzas	8
Hutch	10
Files	12
Bookcases	14
TV Cabinets	16
Handles	18
Knobs	18
Handles & Knobs	18
Wood/Stain	18
Laminates	19



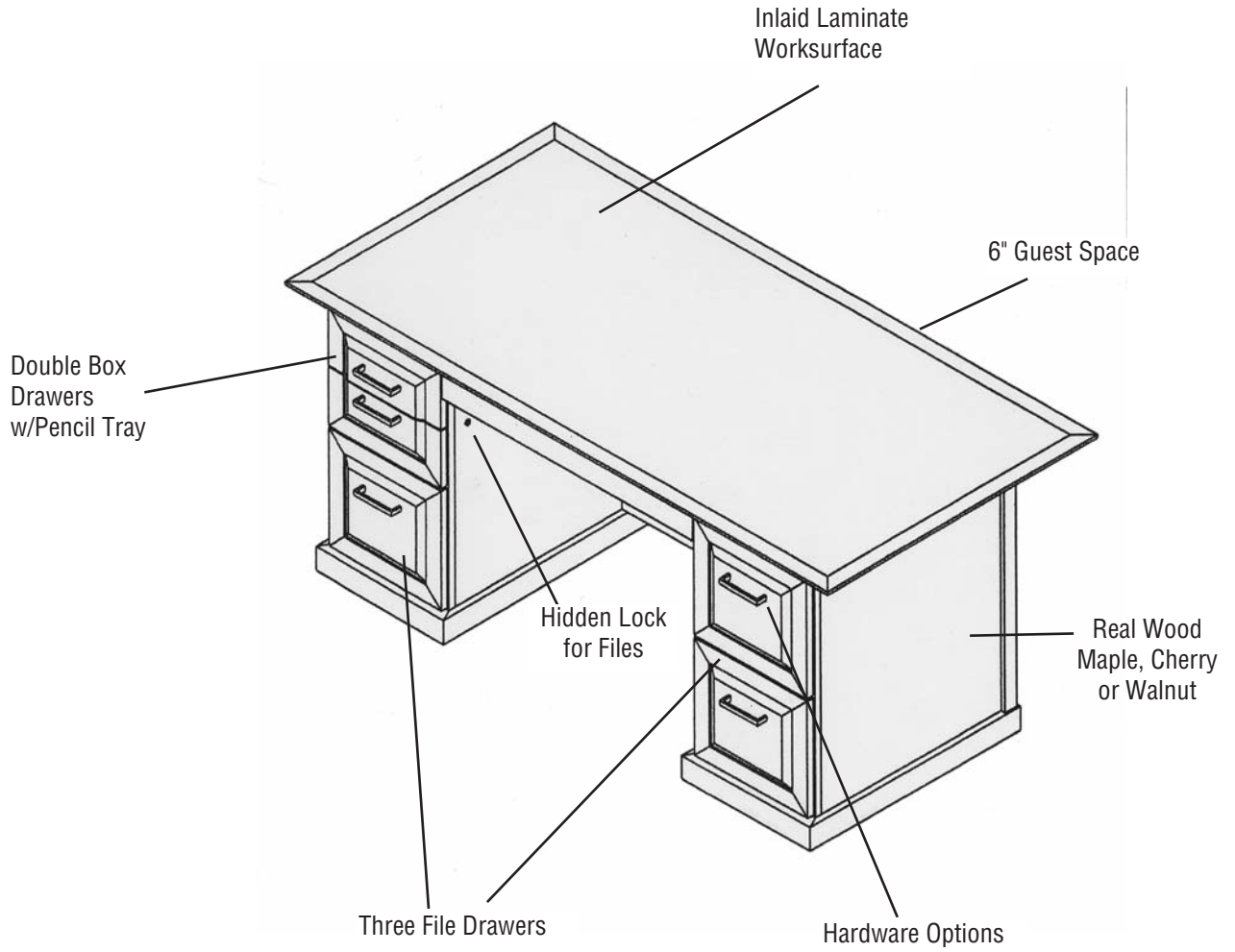

Model Number

D X L	Basic Model	Height	Door/Drawers	Handles	Top Trim	Bottom Trim	Laminate Colors	Wood/Stain	File Option
36x72	TRD3672	<input type="checkbox"/>	FR	HA	ST	SL	<input type="checkbox"/>	<input type="checkbox"/>	<input type="checkbox"/>
36x72	TRD3672	<input type="checkbox"/>	FR	HA	SQ	SL	<input type="checkbox"/>	<input type="checkbox"/>	<input type="checkbox"/>
36x72	TRD3672	<input type="checkbox"/>	FR	HA	KN	SL	<input type="checkbox"/>	<input type="checkbox"/>	<input type="checkbox"/>
36x72	TRD3672	<input type="checkbox"/>	FR	HA	ST	EG	<input type="checkbox"/>	<input type="checkbox"/>	<input type="checkbox"/>
36x72	TRD3672	<input type="checkbox"/>	FR	HA	SQ	EG	<input type="checkbox"/>	<input type="checkbox"/>	<input type="checkbox"/>
36x72	TRD3672	<input type="checkbox"/>	FR	HA	KN	EG	<input type="checkbox"/>	<input type="checkbox"/>	<input type="checkbox"/>
	A	B	C	D	E	F	G	H	I

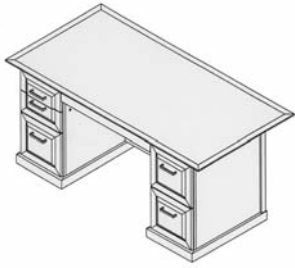

Executive Desk

- Classic executive styling
- Solid wood construction with durable, trimmed, laminate top
- 6" overhang for visitor leg room
- Removable pencil tray
- Locking Box/Box/File and File/File
- Drawers have handles only



HOW TO ORDER

Indicate the following information on order form:

- Quantity of each item.
- Model Number, including options. See "How to Build a Model Number".
- Any special service required.

Note: ● The indicates that a choice is required.
 ● The absence of the indicates that no choice is required
 ● Alpha-numeric characters in place of indicate that no other alternatives are available.

HOW TO BUILD A MODEL NUMBER

A Select basic model.

B Height.
D = 30" Height _____
A = 32" Height _____

C Door/Drawer.
FR = Framed _____

D Select handle style.
HA = Handles _____
 (Specify selection from chart on page 18)

E Select top trim.
ST = Step _____
SQ = Square _____

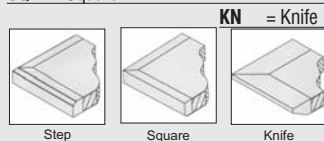

F Select bottom trim.
SL = Simple _____
EG = Elegant _____

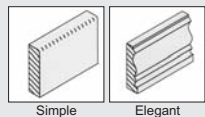

G Select laminate surface
SP = Specify Laminate from page 19 _____
CP = Specify Customer Selection _____

H Select wood/stain option.
M = Natural Maple _____
C = Natural Cherry _____
D = Dark Cherry _____
W = Medium Walnut _____
 See selection chart on page 18

I Select file option.
L = Box/Box File(Left) File/File (Right) _____
R = Box/Box File(Right) File/File (Left) _____

List Price

Natural Maple	Natural Cherry	Dark Cherry	Medium Walnut
\$3913	\$4003	\$4003	\$4039
3733	3823	3823	3859
3994	4084	4084	4120
4093	4183	4183	4219
3913	4003	4003	4039
4174	4264	4264	4300

PRICING INFORMATION

Prices shown are List Prices
 Standard Discount Method for Products in this Price List for all BSI Customers:
 56% Discount for Product Only
 For dock delivery add 5% of net price.
 For installation add an additional 8% of net price.

SHIPPING

Packing/Shipping shall be at the discretion of BSI and is dependent upon sizes and quantities in each order.

Specifications and prices may be subject to change without prior notice.

Model Number

D X L	Basic Model	Height	Door/ Drawers	Handles	Top Trim	Bottom Trim	Laminate Colors	Wood/ Stain	End Option
84x84	TRLDL8484	<input type="checkbox"/>	FR	HA	ST	SL	<input type="checkbox"/> <input type="checkbox"/>	<input type="checkbox"/>	<input type="checkbox"/>
84x84	TRLDL8484	<input type="checkbox"/>	FR	HA	SQ	SL	<input type="checkbox"/> <input type="checkbox"/>	<input type="checkbox"/>	<input type="checkbox"/>
84x84	TRLDL8484	<input type="checkbox"/>	FR	HA	ST	EG	<input type="checkbox"/> <input type="checkbox"/>	<input type="checkbox"/>	<input type="checkbox"/>
84x84	TRLDL8484	<input type="checkbox"/>	FR	HA	SQ	EG	<input type="checkbox"/> <input type="checkbox"/>	<input type="checkbox"/>	<input type="checkbox"/>
84x84	TRLDR8484	<input type="checkbox"/>	FR	HA	ST	SL	<input type="checkbox"/> <input type="checkbox"/>	<input type="checkbox"/>	<input type="checkbox"/>
84x84	TRLDR8484	<input type="checkbox"/>	FR	HA	SQ	SL	<input type="checkbox"/> <input type="checkbox"/>	<input type="checkbox"/>	<input type="checkbox"/>
84x84	TRLDR8484	<input type="checkbox"/>	FR	HA	ST	EG	<input type="checkbox"/> <input type="checkbox"/>	<input type="checkbox"/>	<input type="checkbox"/>
84x84	TRLDR8484	<input type="checkbox"/>	FR	HA	SQ	EG	<input type="checkbox"/> <input type="checkbox"/>	<input type="checkbox"/>	<input type="checkbox"/>

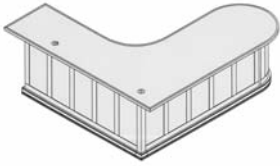

“L” Shaped Desk - Left

- Contemporary executive styling
- Solid wood construction with durable, trimmed, laminate top
- 6” overhang for visitor leg room
- Locking Box/Box/File
- Drawers have handles only

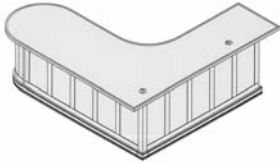

“L” Shaped Desk - Right

- Contemporary executive styling
- Solid wood construction with durable, trimmed, laminate top
- 6” overhang for visitor leg room
- Locking Box/Box/File
- Drawers have handles only



HOW TO ORDER

Indicate the following information on order form:

1. Quantity of each item.
2. Model Number, including options. See “How to Build a Model Number”.
3. Any special service required.

- Note:
- The indicates that a choice is required.
 - The absence of the indicates that no choice is required
 - Alpha-numeric characters in place of Indicate that no other alternatives are available.

HOW TO BUILD A MODEL NUMBER

A Select basic model.

B Height.

D = 30” Height _____

A = 32” Height _____

C Door/Drawer.

FR = Framed _____

D Select handle style.

HA = Handles _____

Specify selection from chart on page 18

E Select top trim.

ST = Step _____

SQ = Square _____



Step



Square

F Select bottom trim.

SL = Simple _____

EG = Elegant _____

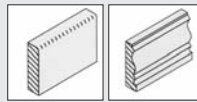

Simple

Elegant

G Select laminate surface

SP = Specify Laminate from page 19 _____

CP = Specify Customer Selection _____

H Select wood/stain option.

M = Natural Maple _____

C = Natural Cherry _____

D = Dark Cherry _____

W = Medium Walnut _____

See selection chart on page 18

I Select end option.

C = Closed End _____

B = Bookcase End _____

List Price

Natural Maple	Natural Cherry	Dark Cherry	Medium Walnut
\$6150	\$6275	\$6275	\$6325
5900	6025	6025	6075
6400	6525	6525	6575
6150	6275	6275	6325
\$6150	\$6275	\$6275	\$6325
5900	6025	6025	6075
6400	6525	6525	6575
6150	6275	6275	6325

PRICING INFORMATION
 Prices shown are List Prices
 Standard Discount Method for Products in this Price List for all BSI Customers:
 56% Discount for Product Only
 For dock delivery add 5% of net price.
 For installation add an additional 8% of net price.

SHIPPING
 Packing/Shipping shall be at the discretion of BSI and is dependent upon sizes and quantities in each order.

Specifications and prices may be subject to change without prior notice.

Model Number

D X L	Basic Model	Height	Door/ Drawers	Handles	Top Trim	Bottom Trim	Laminate Colors	Wood/ Stain
Credenza - All Doors								
	24X72 TRCF2472	<input type="checkbox"/>	FR	<input type="checkbox"/>	ST	SL	<input type="checkbox"/>	<input type="checkbox"/>
	24X72 TRCF2472	<input type="checkbox"/>	FR	<input type="checkbox"/>	SQ	SL	<input type="checkbox"/>	<input type="checkbox"/>
	24X72 TRCF2472	<input type="checkbox"/>	FR	<input type="checkbox"/>	KN	SL	<input type="checkbox"/>	<input type="checkbox"/>
	24X72 TRCF2472	<input type="checkbox"/>	FR	<input type="checkbox"/>	CR	SL	<input type="checkbox"/>	<input type="checkbox"/>
	24X72 TRCF2472	<input type="checkbox"/>	FR	<input type="checkbox"/>	ST	EG	<input type="checkbox"/>	<input type="checkbox"/>
	24X72 TRCF2472	<input type="checkbox"/>	FR	<input type="checkbox"/>	SQ	EG	<input type="checkbox"/>	<input type="checkbox"/>
	24X72 TRCF2472	<input type="checkbox"/>	FR	<input type="checkbox"/>	KN	EG	<input type="checkbox"/>	<input type="checkbox"/>
	24X72 TRCF2472	<input type="checkbox"/>	FR	<input type="checkbox"/>	CR	EG	<input type="checkbox"/>	<input type="checkbox"/>
Credenza - Doors and Drawers								
	24X72 TRCD2472	<input type="checkbox"/>	FR	<input type="checkbox"/>	ST	SL	<input type="checkbox"/>	<input type="checkbox"/>
	24X72 TRCD2472	<input type="checkbox"/>	FR	<input type="checkbox"/>	SQ	SL	<input type="checkbox"/>	<input type="checkbox"/>
	24X72 TRCD2472	<input type="checkbox"/>	FR	<input type="checkbox"/>	KN	SL	<input type="checkbox"/>	<input type="checkbox"/>
	24X72 TRCD2472	<input type="checkbox"/>	FR	<input type="checkbox"/>	CR	SL	<input type="checkbox"/>	<input type="checkbox"/>
	24X72 TRCD2472	<input type="checkbox"/>	FR	<input type="checkbox"/>	ST	EG	<input type="checkbox"/>	<input type="checkbox"/>
	24X72 TRCD2472	<input type="checkbox"/>	FR	<input type="checkbox"/>	SQ	EG	<input type="checkbox"/>	<input type="checkbox"/>
	24X72 TRCD2472	<input type="checkbox"/>	FR	<input type="checkbox"/>	KN	EG	<input type="checkbox"/>	<input type="checkbox"/>
	24X72 TRCD2472	<input type="checkbox"/>	FR	<input type="checkbox"/>	CR	EG	<input type="checkbox"/>	<input type="checkbox"/>
Credenza - Pedestals on the end/ Open in the middle								
	24X72 TRCO2472	<input type="checkbox"/>	FR	HA	ST	SL	<input type="checkbox"/>	<input type="checkbox"/>
	24X72 TRCO2472	<input type="checkbox"/>	FR	HA	SQ	SL	<input type="checkbox"/>	<input type="checkbox"/>
	24X72 TRCO2472	<input type="checkbox"/>	FR	HA	KN	SL	<input type="checkbox"/>	<input type="checkbox"/>
	24X72 TRCO2472	<input type="checkbox"/>	FR	HA	CR	SL	<input type="checkbox"/>	<input type="checkbox"/>
	24X72 TRCO2472	<input type="checkbox"/>	FR	HA	ST	EG	<input type="checkbox"/>	<input type="checkbox"/>
	24X72 TRCO2472	<input type="checkbox"/>	FR	HA	SQ	EG	<input type="checkbox"/>	<input type="checkbox"/>
	24X72 TRCO2472	<input type="checkbox"/>	FR	HA	KN	EG	<input type="checkbox"/>	<input type="checkbox"/>
	24X72 TRCO2472	<input type="checkbox"/>	FR	HA	CR	EG	<input type="checkbox"/>	<input type="checkbox"/>
	A	B	C	D	E	F	G	H

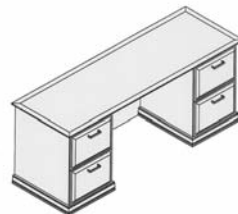
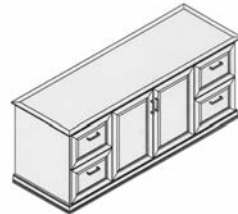
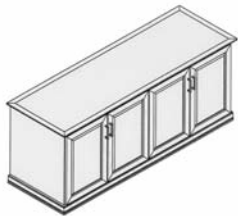

- **Credenza - All Doors**
- Classic executive styling
- Solid wood construction with durable, trimmed, laminate top
- Four fixed shelves
- Four locking doors
- Available with handles only or knobs only

- **Credenza - Doors and Drawers**
- Classic executive styling
- Solid wood construction with durable, trimmed, laminate top
- Four- 12" locking file drawers
- Center cabinet with two fixed shelves
- Available with drawer handles and door knobs or handles only

- **Credenza - Pedestals on the end/
Open in the middle**
- Classic executive styling
- Solid wood construction with durable, trimmed, laminate top
- Locking file drawers on each end
- Available with handles only



HOW TO ORDER

Indicate the following information on order form:

1. Quantity of each item.
2. Model Number, including options. See "How to Build a Model Number".
3. Any special service required.

- Note:
- The indicates that a choice is required.
 - The absence of the indicates that no choice is required
 - Alpha-numeric characters in place of Indicate that no other alternatives are available.

HOW TO BUILD A MODEL NUMBER

- A Select basic model.**
D = 30" Height
A = 32" Height
- C Door/Drawer.**
FR = Framed
- D Select handle/knob style.**
HB = Knobs
HA = Handles
HK = Handles & Knobs
(Specify selection from chart on page 18)

- E Select top trim.**
ST = Step
SQ = Square
KN = Knife

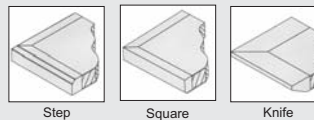

- F Select bottom trim.**
SL = Simple
EG = Elegant

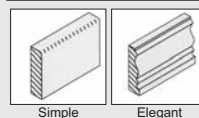

- G Select laminate surface**
SP = Specify Laminate from page 19
CP = Specify Customer Selection

- H Select wood/stain option.**
M = Natural Maple
C = Natural Cherry
D = Dark Cherry
W = Medium Walnut
See selection chart on page 18

List Price

Natural Maple	Natural Cherry	Dark Cherry	Medium Walnut
\$4338	\$4428	\$4428	\$4464
4158	4248	4248	4284
4419	4509	4509	4545
4338	4428	4428	4464
4518	4608	4608	4644
4338	4428	4428	4464
4599	4689	4689	4725
4518	4608	4608	4644
4788	4878	4878	4914
4608	4698	4698	4734
4869	4959	4959	4995
4788	4878	4878	4914
4968	5058	5058	5094
4788	4878	4878	4914
5049	5139	5139	5175
4968	5058	5058	5094
4438	4528	4528	4564
4258	4348	4348	4384
4519	4609	4609	4645
4438	4528	4528	4564
4618	4708	4708	4744
4438	4528	4528	4564
4699	4789	4789	4825
4618	4708	4708	4744

PRICING INFORMATION

Prices shown are List Prices
 Standard Discount Method for Products in this Price List for all BSI Customers: 56% Discount for Product Only
 For dock delivery add 5% of net price.
 For installation add an additional 8% of net price.

SHIPPING

Packing/Shipping shall be at the discretion of BSI and is dependent upon sizes and quantities in each order.

Specifications and prices may be subject to change without prior notice.

Model Number

D X L	Basic Model	Door/Drawers	Handles	Top Trim	Wood/Stain
12x72	TRH72	FR	<input type="checkbox"/> <input type="checkbox"/>	SQ	<input type="checkbox"/>
12x72	TRDH72	FR	<input type="checkbox"/> <input type="checkbox"/>	CR	<input type="checkbox"/>
12x72	TRDH72	FR	<input type="checkbox"/> <input type="checkbox"/>	KN	<input type="checkbox"/>
	A	B	C	D	E

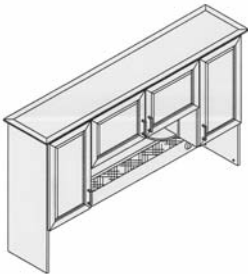

Hutch

- Classic executive styling
- Solid wood construction
- End cabinets have two adjustable shelves
- Two corner accent shelves
- Recessed lighting
- Grommets
- Tackboard
- Available with handles only or knobs only



HOW TO ORDER

Indicate the following information on order form:

1. Quantity of each item.
2. Model Number, including options. See "How to Build a Model Number".
3. Any special service required.

Note:

- The indicates that a choice is required.
- The absence of the indicates that no choice is required
- Alpha-numeric characters in place of indicate that no other alternatives are available.

HOW TO BUILD A MODEL NUMBER

A Select basic model.

B Door/Drawer.

FR = Framed

C Select knob style.

HB = Knobs

HA = Handles

(Specify selection from chart on page 18)

D Select top trim.

SQ = Square

CR = Crown

KN = Knife



Square



Crown



Knife

E Select wood/stain option.

M = Natural Maple

C = Natural Cherry

D = Dark Cherry

W = Medium Walnut

See selection chart on page 18

Specify tackboard fabric.

List Price

Natural Maple	Natural Cherry	Dark Cherry	Medium Walnut
\$2945	\$2980	\$2980	\$2994
3085	3120	3120	3134
3148	3183	3183	3197

PRICING INFORMATION

Prices shown are List Prices
 Standard Discount Method for Products in this Price List for all BSI Customers:
 56% Discount for Product Only
 For dock delivery add 5% of net price.
 For installation add an additional 8% of net price.

SHIPPING

Packing/Shipping shall be at the discretion of BSI and is dependent upon sizes and quantities in each order.

Specifications and prices may be subject to change without prior notice.

Model Number



Lateral File

- Classic executive styling
- Solid wood construction with durable laminate top
- Two drawer cabinet
- Hidden Lock
- Accepts hanging front to back and side to side filing
- Available with handles only

D X L	Basic Model	Door/Drawers	Handles	Top Trim	Bottom Trim	Laminate Colors	Wood/Stain
24x42	TRL42	FR	HA	ST	SL	<input type="checkbox"/> <input type="checkbox"/>	<input type="checkbox"/>
24x42	TRL42	FR	HA	SQ	SL	<input type="checkbox"/> <input type="checkbox"/>	<input type="checkbox"/>
24x42	TRL42	FR	HA	KN	SL	<input type="checkbox"/> <input type="checkbox"/>	<input type="checkbox"/>
24x42	TRL42	FR	HA	ST	EG	<input type="checkbox"/> <input type="checkbox"/>	<input type="checkbox"/>
24x42	TRL42	FR	HA	SQ	EG	<input type="checkbox"/> <input type="checkbox"/>	<input type="checkbox"/>
24x42	TRL42	FR	HA	KN	EG	<input type="checkbox"/> <input type="checkbox"/>	<input type="checkbox"/>



Vertical File

- Classic executive styling
- Solid wood construction with durable laminate top
- Four locking file drawers
- Accepts hanging files front to back
- Available with handles only

28x56	TRV4D	FR	HA	ST	SL	<input type="checkbox"/> <input type="checkbox"/>	<input type="checkbox"/>
28x56	TRV4D	FR	HA	SQ	SL	<input type="checkbox"/> <input type="checkbox"/>	<input type="checkbox"/>
28x56	TRV4D	FR	HA	KN	SL	<input type="checkbox"/> <input type="checkbox"/>	<input type="checkbox"/>
28x56	TRV4D	FR	HA	ST	EG	<input type="checkbox"/> <input type="checkbox"/>	<input type="checkbox"/>
28x56	TRV4D	FR	HA	SQ	EG	<input type="checkbox"/> <input type="checkbox"/>	<input type="checkbox"/>
28x56	TRV4D	FR	HA	KN	EG	<input type="checkbox"/> <input type="checkbox"/>	<input type="checkbox"/>

	A	C	B	C	D	E	F
--	---	---	---	---	---	---	---



HOW TO ORDER

Indicate the following information on order form:

1. Quantity of each item.
2. Model Number, including options. See "How to Build a Model Number".
3. Any special service required.

Note: ● The indicates that a choice is required.
 ● The absence of the indicates that no choice is required
 ● Alpha-numeric characters in place of Indicate that no other alternatives are available.

HOW TO BUILD A MODEL NUMBER

A Select basic model.

FR = Framed _____

B Door/Drawer.

FR = Framed _____

C Select handle style.

HA = Handles _____
 Specify selection from chart on page 18

D Select top trim.

ST = Step _____
SQ = Square _____
KN = Knife _____

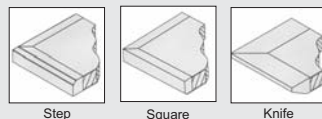

E Select bottom trim.

SL = Simple _____
EG = Elegant _____

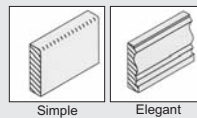

F Select laminate surface

SP = Specify Laminate from page 19 _____
CP = Specify Customer Selection _____

G Select wood/stain option.

M = Natural Maple _____
C = Natural Cherry _____
D = Dark Cherry _____
W = Medium Walnut _____
 See selection chart on page 18

List Price

Natural Maple	Natural Cherry	Dark Cherry	Medium Walnut
\$2578	\$2606	\$2606	\$2617
2523	2551	2551	2562
2602	2630	2630	2641
2633	2661	2661	2672
2578	2606	2606	2617
2657	2685	2685	2696
2412	2447	2447	2461
2342	2377	2377	2391
2444	2479	2479	2493
2482	2517	2517	2531
2412	2447	2447	2461
2414	2549	2549	2563

PRICING INFORMATION

Prices shown are List Prices
 Standard Discount Method for Products in this Price List for all BSI Customers: 56% Discount for Product Only
 For dock delivery add 5% of net price.
 For installation add an additional 8% of net price.

SHIPPING

Packing/Shipping shall be at the discretion of BSI and is dependent upon sizes and quantities in each order.

Specifications and prices may be subject to change without prior notice.

Model Number



Bookcase

- Classic executive styling
- Solid wood construction
- 48" high bookcase
2-adjustable shelves
- 60 high bookcase
3-adjustable shelves
- 72" high bookcase
4-adjustable shelves

D X W X H	Basic Model	Top Trim	Bottom Trim	Wood/Stain
15x34x48	TRB48	SQ	SL	<input type="checkbox"/>
15x34x48	TRB48	KN	SL	<input type="checkbox"/>
15x34x48	TRB48	CR	SL	<input type="checkbox"/>
15x34x48	TRB48	SQ	EG	<input type="checkbox"/>
15x34x48	TRB48	KN	EG	<input type="checkbox"/>
15x34x48	TRB48	CR	EG	<input type="checkbox"/>
15x34x60	TRB60	SQ	SL	<input type="checkbox"/>
15x34x60	TRB60	KN	SL	<input type="checkbox"/>
15x34x60	TRB60	CR	SL	<input type="checkbox"/>
15x34x60	TRB60	SQ	EG	<input type="checkbox"/>
15x34x60	TRB60	KN	EG	<input type="checkbox"/>
15x34x60	TRB60	CR	EG	<input type="checkbox"/>
15x34x72	TRB72	SQ	SL	<input type="checkbox"/>
15x34x72	TRB72	KN	SL	<input type="checkbox"/>
15x34x72	TRB72	CR	SL	<input type="checkbox"/>
15x34x72	TRB72	SQ	EG	<input type="checkbox"/>
15x34x72	TRB72	KN	EG	<input type="checkbox"/>
15x34x72	TRB72	CR	EG	<input type="checkbox"/>
		A	B	C
				D



HOW TO ORDER

Indicate the following information on order form:

1. Quantity of each item.
2. Model Number, including options.
See "How to Build a Model Number".
3. Any special service required.

- Note:
- The indicates that a choice is required.
 - The absence of the indicates that no choice is required
 - Alpha-numeric characters in place of Indicate that no other alternatives are available.

HOW TO BUILD A MODEL NUMBER

A Select basic model.

- SQ** = Square
CR = Crown
KN = Knife

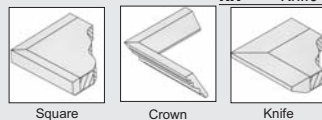

C Select bottom trim.

- SL** = Simple
EG = Elegant

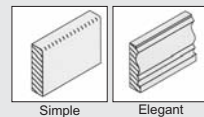

D Select wood/stain option.

- M** = Natural Maple
C = Natural Cherry
D = Dark Cherry
W = Medium Walnut

See selection chart on page 18

List Price

Natural Maple	Natural Cherry	Dark Cherry	Medium Walnut
\$2535	\$2563	\$2563	\$2574
2614	2642	2642	2653
2590	2618	2618	2629
2690	2618	2618	2629
2669	2697	2697	2708
2645	2673	2673	2684
2687	2715	2715	2726
2766	2794	2794	2805
2742	2770	2770	2781
2742	2770	2770	2781
2821	2849	2849	2860
2797	2825	2825	2836
2841	2869	2869	2880
2920	2948	2948	2959
2896	2924	2924	2935
2896	2924	2924	2935
2975	3003	3003	3014
2951	2979	2979	2990

PRICING INFORMATION

Prices shown are List Prices
 Standard Discount Method for Products in this Price List for all BSI Customers: 56% Discount for Product Only
 For dock delivery add 5% of net price.
 For installation add an additional 8% of net price.

SHIPPING

Packing/Shipping shall be at the discretion of BSI and is dependent upon sizes and quantities in each order.

Specifications and prices may be subject to change without prior notice.

Model Number

D X L	Basic Model	Door/Drawers	Handles	Top Trim	Bottom Trim	Laminate Colors	Wood/Stain
24x77	TRTV	FR	HA	ST	SL	□□	□
24x77	TRTV	FR	HA	SQ	SL	□□	□
24x77	TRTV	FR	HA	KN	SL	□□	□
24x77	TRTV	FR	HA	CR	SL	□□	□
24x77	TRTV	FR	HA	ST	EG	□□	□
24x77	TRTV	FR	HA	SQ	EG	□□	□
24x77	TRTV	FR	HA	KN	EG	□□	□
24x77	TRTV	FR	HA	CR	EG	□□	□

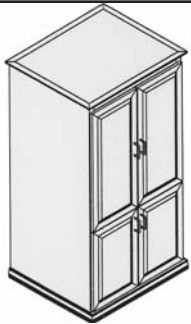

TV/VCR Cabinet

- Classic executive styling
- Solid wood construction
- 1 adjustable shelf
- 1 fixed shelf
- Casters
- Locking unit
- Doors slide into the cabinet for easy viewing
- Available with handles only or knobs only

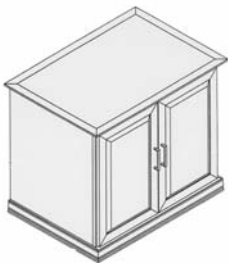

TV Cabinet Stand

- Classic executive styling
- Solid wood construction with durable laminate top
- 1 adjustable shelf
- Locking unit
- Casters
- Available with handles only or knobs only

30X32	TRTS	FR	HA	ST	SL	□□	□
28x56	TRV4D	FR	HA	SQ	SL	□□	□
28x56	TRV4D	FR	HA	KN	SL	□□	□
28x56	TRV4D	FR	HA	CR	SL	□□	□
30X32	TRTS	FR	HA	ST	EG	□□	□
28x56	TRV4D	FR	HA	SQ	EG	□□	□
28x56	TRV4D	FR	HA	KN	EG	□□	□
28x56	TRV4D	FR	HA	CR	EG	□□	□

A B C D E F G



HOW TO ORDER

Indicate the following information on order form:

- Quantity of each item.
- Model Number, including options. See "How to Build a Model Number".
- Any special service required.

- Note:
- The □ indicates that a choice is required.
 - The absence of the □ indicates that no choice is required
 - Alpha-numeric characters in place of □ Indicate that no other alternatives are available.

HOW TO BUILD A MODEL NUMBER

A Select basic model.

B Door/Drawer.
FR = Framed

C Select knob style.
HA = Handles

See selection chart on page 18

D Select top trim.
SQ = Square
CR = Crown
KN = Knife

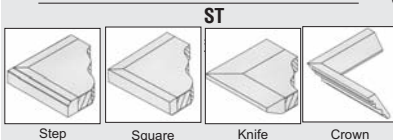

E Select bottom trim.

SL = Simple
EG = Elegant

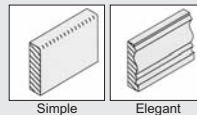

F Select laminate surface

SP = Specify Laminate from page 19
CP = Specify Customer Selection

G Select wood/stain option.

M = Natural Maple
C = Natural Cherry
D = Dark Cherry
W = Medium Walnut

See selection chart on page 18

List Price

Natural Maple	Natural Cherry	Dark Cherry	Medium Walnut
\$2955	\$2980	\$2980	\$2990
2905	2930	2930	2940
2978	3003	3003	3013
2955	2980	2980	2990
3005	3030	3030	3040
2955	2980	2980	2990
3028	3053	3053	3063
3005	3030	3030	3040
1597	1622	1622	1632
1547	1572	1572	1582
1620	1645	1645	1655
1597	1622	1622	1632
1647	1672	1672	1682
1597	1622	1622	1632
1670	1695	1695	1705
1647	1672	1672	1682

PRICING INFORMATION

Prices shown are List Prices
 Standard Discount Method for Products in this Price List for all BSI Customers: 56% Discount for Product Only
 For dock delivery add 5% of net price.
 For installation add an additional 8% of net price.

SHIPPING

Packing/Shipping shall be at the discretion of BSI and is dependent upon sizes and quantities in each order.

Specifications and prices may be subject to change without prior notice.

Handles

TRIUMPH SWATCHES



Knobs



Wood/Stain

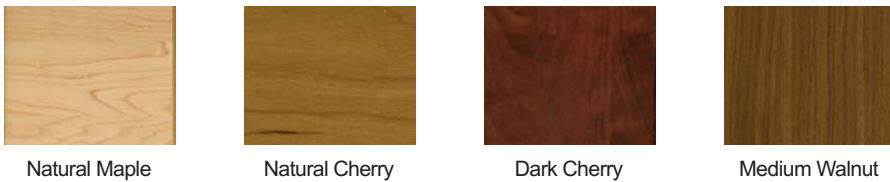

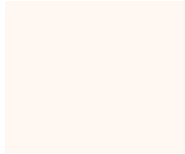

Frosty White
Wilsonart
#1573-60

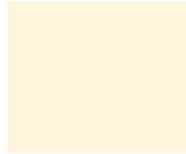

White Sand
Wilsonart
#D403-60

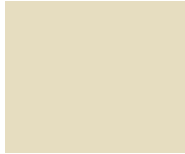

Putty
Wilsonart
#1508-60

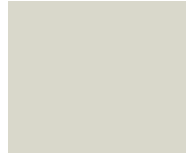

Grey
Wilsonart
#1500-60



Fossil Grey
Nevemar
#S6031T



Grey Moss
Wilsonart
15008-60



Weathered Grey
Micarta
#ST9154E



Garden Mist
Nevemar
#SG0004T



Silicon EV
Wilsonart
#4811-60



Tungsten EV
Wilsonart
#4814-60



Copper EV
Wilsonart
#4818-60



Titanium EV
Wilsonart
#4810-60

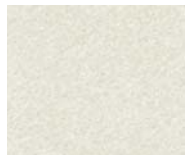

Oxygen EV
Wilsonart
#4809-60



Radium EV
Wilsonart
#4812-60



Nickel EV
Wilsonart
#4813-60



Cesium EV
Wilsonart
#4815-60



Karratha Brush
Wilsonart
#4744-60



Maroochy Bush
Wilsonart
#4745-60



Illawarra Brush
Wilsonart
4806-60

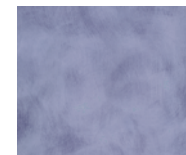

Barcoo Brush
Wilson Art
#4821-60



Woolamai Brush
Wilsonart
#4746-60



Wild Oats Matrix
Nevemar
#MR7002T



Straw Matrix
Nevemar
#MR2006T



Greige Matrix
Nevemar
#MR2002T



Frech Blue Matrix
Nevemar
#MR3003T



Winter Grey Matrix
Nevemar
#MR6005T



Storm Grey Matrix
Micarta
#51M40E



Charcoal Matrix
Nevemar
#MR6002T



Kensington Maple
Wilsonart
#10776-38



Monticello Maple
Wilsonart
#7925*38



Castle Oak
Wilsonart
#7928-38



Cherry Storm
Wilsonart
#7054-38

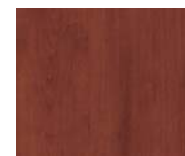

Biltmore Cherry
Wilsonart
#7924-38

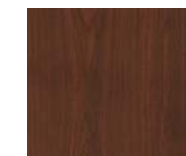

Brighton Walnut
Wilsonart
#7885T-60

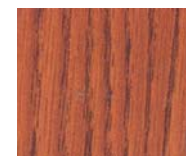

English Oak (HT)
Wilson Art
#7885T-60



Recon Oak
Nevemar
#WZ-0005N



Regency Walnut
Formica Winchester
#385-58



Victoria Mahogany
Formica
#7583

Buying from BSI can make a real difference.

You are supporting Wisconsin companies, which add to the tax base and employ our taxpaying citizens.

You are helping save taxpayer money through promotion of successful reintegration of offenders into our communities.

You are promoting environmental responsibility through the use of "green" products and development of alternative fuels.

Revenues earned are reinvested in recycling initiatives to keep our landfills safe of pollutants.

Revenues are used to develop meaningful vocational programs for training inmates for release.

You are helping us make our institutions safer by reducing inmate idleness.

Low Prices!

It's Quick and Easy!

One stop shopping for a wide variety of quality products.



Showroom and Business Office

3099 East Washington Ave..

Madison, Wisconsin 53704

PHONE: 608-240-5200

FAX: 608-240-3321

TOLL FREE: 800-862-1086

Web site: www.buybsi.com